

1. Drill and tap hole per drill chart.
2. Clear drill .060-.200 to account for a max. of 2 threads under the head.
3. Screw MITEE-BITE KNIFE EDGE CLAMP all the way down, then back off one turn. Can also be tightened counter clockwise.
4. Insert part and tighten MITEE-BITE screw.
5. CAUTION! Never assume clamp is tight, ALWAYS tighten clamp prior to machining.

**NOTE:** When using this style of clamp please ensure hard stop is recessed in slot or pinned and equal to or greater than height of clamp. This will prevent part from lifting.

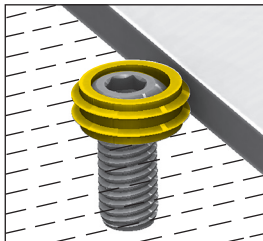

## DRILL CHART

DISTANCE FROM EDGE OF WORKPIECE

Model #	Thd. Size	Distance
MB-6 .....	3/8-16 .....	.400
MB-8 .....	1/2-13 .....	.500
MB-10 .....	5/8-11.....	.590



**WARNING:** This product may contain a chemical known to the State of California to cause cancer or birth defects or other reproductive harm.  
[www.P65Warnings.ca.gov](http://www.P65Warnings.ca.gov)