

Advant-Edge Clamp Instructions

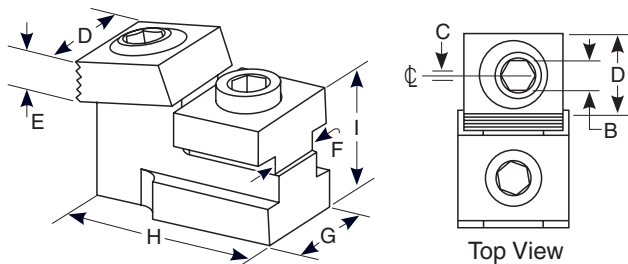

1. Insert clamp in t-slot.
2. Tighten cam screw all the way down, then back off approximately one turn.
3. Position cam screw as shown.
4. Hold clamp against workpiece and tighten mounting screw to lock into t-slot.
5. Clamp is now ready to use.

	Part Number	Cam Screw	T-Slot Size	B	C	D	E	F	G	H	I	Torque not to Exceed (Ft Lb/Lbs)	Replacement Square Washer
INCH	52224	50372	5/8	5/16	.080	1.00	.375	.610	1.12	1.89	1.1	65/4,000	51016
	52424 (kit)												
												(N.m./N.)	
METRIC DIMENSIONS			16	8	2	25.4	9.5	16	28.5	48	28	88.00/17800	

Torque mounting bolt to 70 Ft/Lbs (150N.m.).

