

Modular Pitbull® Clamp Instructions

The Pitbull® Fixture Clamp is very well known for its low profile and positive down force. It is now available as a modular clamp in two styles.

The slotted Modular Pitbull® Clamp with a step offers increased versatility through its unique riser design. This clamp supports the workpiece off the machine table for through milling and drilling. The hardened and ground clamps are designed for use on work cubes, as well as machined tables with tapped holes or T-slot configurations.

The compact Modular Pitbull® Clamp is ideal for clamping workpieces in series by using the back surface of a clamp to locate the next workpiece. The back of the clamp is ground square to the bottom for precise location of parts. The height of the clamp can be adjusted by the depth of the milled slot used to locate the clamp.

Both versions are produced in two sizes with holding forces of 16000 and 26000 N.

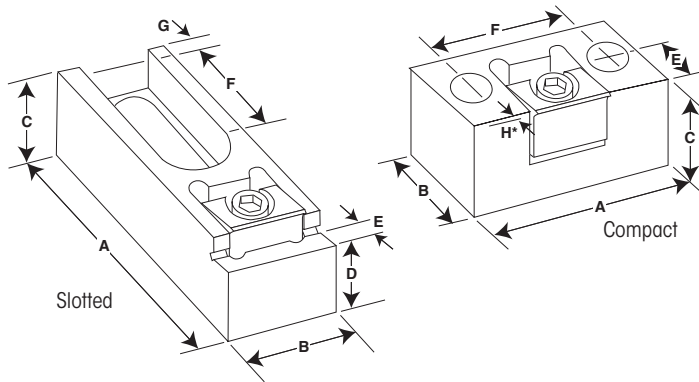

 Pitbull® is a registered trademark of the Pitbull Clamp Co., Inc.

	Part Number		Description	A	B	C	D ^{+0.000} _{-.0005}	E	F	G	H*	Torque not to Exceed (Ft/Lbs)	Holding Force (Lbs)	Mtg. Screw	Slot
	Knife Edge	Blunt Edge													
INCH	26220	26225	Medium/Compact	2.25	1.23	.98	NA	.62	1.50	-	.024	14.5	3,600	5/16	-
	26230	26235	Large/Compact	2.70	1.48	1.24	NA	.74	1.85	-	.050	30.0	6,000	3/8	-
	26240	26245	Medium/Slotted	4.08	1.25	.99	.7300	.36	1.70	.50	.024	14.5	3,600	1/2	Closed
	26250	26255	Large/Slotted	4.20	1.50	1.61	1.3780	.36	1.52	.43	.050	30.0	6,000	5/8	Closed
							D ^{+0.000} _{-.013}					(N.m.)	(N.)		
METRIC	56220	56225	Medium/Compact	57.1	31.242	25.1	NA	15.7	38.1	-	.61	22.5	16000	M8	-
	56230	56235	Large/Compact	68.6	37.592	31.5	NA	18.8	47.0	-	1.27	40.6	26000	M10	-
	56240	56245	Medium/Slotted	103.6	31.700	25.1	18.542	9.1	43.2	12.7	.61	22.5	16000	M12	Closed
	56250	56255	Large/Slotted	107.0	38.100	40.9	35.000	9.1	38.6	10.9	1.27	40.6	26000	M16	Closed

H* - Clamp travel

PATENT NO. 6435496

